

Ergo Tig ER9 and ER9FXL Air Cooled Tig Welding Torch

Rating: 125A DC, 85A AC 0.040" to 3/32" (1.00mm-2.4mm) electrodes

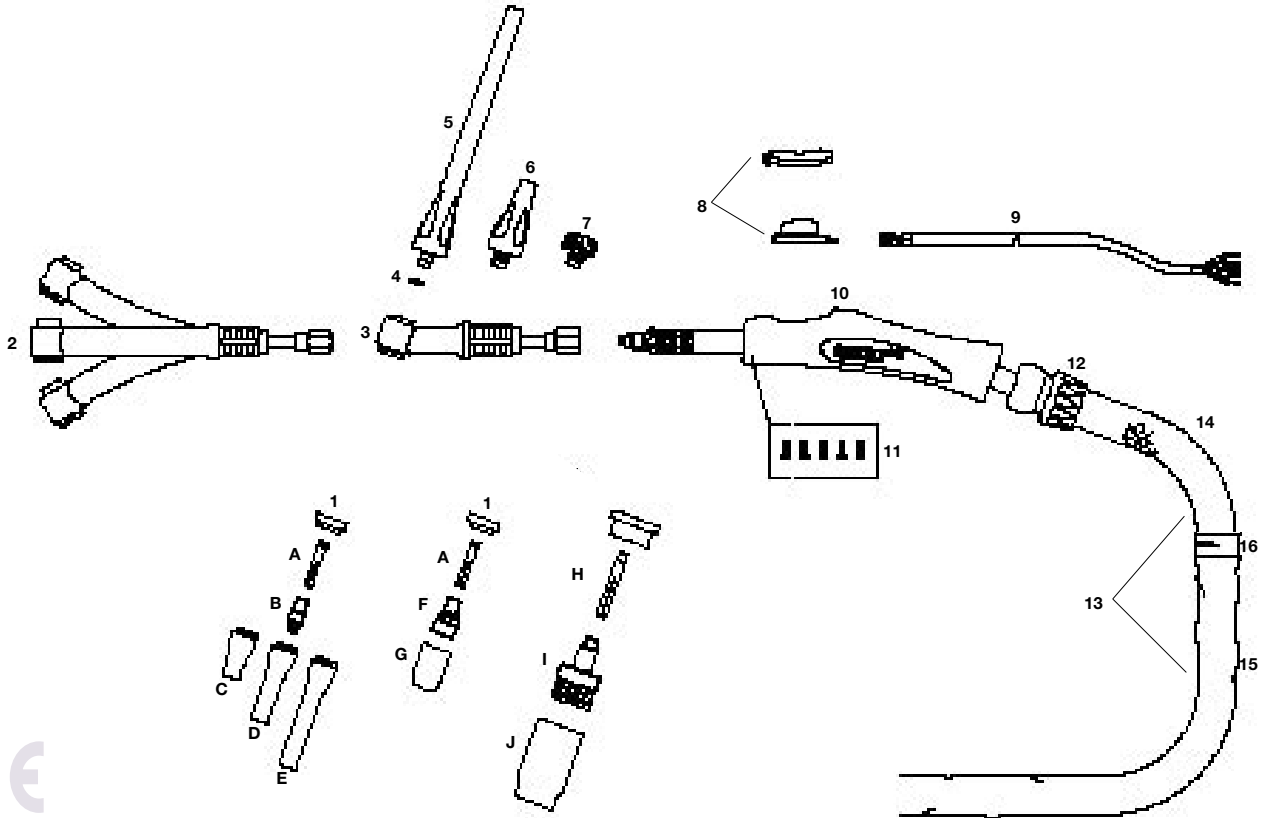

TO ORDER AN ERGO TIG TORCH PACKAGE PLEASE USE THE 5 STAGE PROCESS OUTLINED ON PAGE 1

Example:- ER9-12S1BGO

ER9 Ergo Torch x 12.5ft with momentary switch, 3/8 BSP fittings and 2 pin Amphenol Plug.

Torch Head	Cable Length	Switch Option	Cable Termination	Cable Plug																																																																						
<table border="1" style="width: 100%; border-collapse: collapse;"> <thead> <tr> <th style="text-align: left;">Part No.</th> <th style="text-align: left;">Description</th> </tr> </thead> <tbody> <tr> <td>ER9</td> <td>ER9 125A DC</td> </tr> <tr> <td>ER9FXL</td> <td>ER9FXL 125A DC FLEX</td> </tr> </tbody> </table> <p style="font-size: 8px;">NOTE: See Page 3 for Torch Heads explained</p>	Part No.	Description	ER9	ER9 125A DC	ER9FXL	ER9FXL 125A DC FLEX	<table border="1" style="width: 100%; border-collapse: collapse;"> <thead> <tr> <th style="text-align: left;">Part No.</th> <th style="text-align: left;">Description</th> </tr> </thead> <tbody> <tr> <td>12</td> <td>12.5ft cables (4m) c/w leather cover and sheath</td> </tr> <tr> <td>25</td> <td>25ft cables (8m) c/w leather cover and sheath</td> </tr> </tbody> </table> <p style="font-size: 8px;">NOTE: See Page 21 for Cables explained</p>	Part No.	Description	12	12.5ft cables (4m) c/w leather cover and sheath	25	25ft cables (8m) c/w leather cover and sheath	<table border="1" style="width: 100%; border-collapse: collapse;"> <thead> <tr> <th style="text-align: left;">Part No.</th> <th style="text-align: left;">Description</th> </tr> </thead> <tbody> <tr> <td>S1</td> <td>Momentary Switch</td> </tr> <tr> <td>S2</td> <td>2 Button Momentary</td> </tr> <tr> <td>1K</td> <td>1 Button Momentary +1K Pot</td> </tr> <tr> <td>2K</td> <td>1 Button Momentary +5K Pot</td> </tr> <tr> <td>3K</td> <td>1 Button Momentary +10K Pot</td> </tr> <tr> <td>4K</td> <td>1 Button Momentary +25K Pot</td> </tr> <tr> <td>N</td> <td>Blank</td> </tr> </tbody> </table> <p style="font-size: 8px;">NOTE: See Page 2 for Switchs explained</p>	Part No.	Description	S1	Momentary Switch	S2	2 Button Momentary	1K	1 Button Momentary +1K Pot	2K	1 Button Momentary +5K Pot	3K	1 Button Momentary +10K Pot	4K	1 Button Momentary +25K Pot	N	Blank	<p>UK/European Cable Termination</p> <table border="1" style="width: 100%; border-collapse: collapse;"> <thead> <tr> <th style="text-align: left;">Part No.</th> <th style="text-align: left;">Description</th> </tr> </thead> <tbody> <tr> <td>BG</td> <td>Single 3/8BSP connection</td> </tr> <tr> <td>EG</td> <td>Central connector</td> </tr> <tr> <td>WG</td> <td>WTG connector</td> </tr> <tr> <td>LG</td> <td>L-TEC euro</td> </tr> </tbody> </table> <p>USA Cable Termination</p> <table border="1" style="width: 100%; border-collapse: collapse;"> <thead> <tr> <th style="text-align: left;">Part No.</th> <th style="text-align: left;">Description</th> </tr> </thead> <tbody> <tr> <td>US</td> <td>Lug on power, 5/8 UNF RH male on gas</td> </tr> <tr> <td>UN</td> <td>Single 5/8 UNF RH male</td> </tr> <tr> <td>UD</td> <td>3595 Dinse on power, 5/8 UNF RH male on gas</td> </tr> </tbody> </table> <p style="font-size: 8px;">NOTE: See Page 22 for Terminations explained</p>	Part No.	Description	BG	Single 3/8BSP connection	EG	Central connector	WG	WTG connector	LG	L-TEC euro	Part No.	Description	US	Lug on power, 5/8 UNF RH male on gas	UN	Single 5/8 UNF RH male	UD	3595 Dinse on power, 5/8 UNF RH male on gas	<table border="1" style="width: 100%; border-collapse: collapse;"> <thead> <tr> <th style="text-align: left;">Part No.</th> <th style="text-align: left;">Description</th> </tr> </thead> <tbody> <tr> <td>0</td> <td>2 Pin Amphenol Plug</td> </tr> <tr> <td>1</td> <td>4 Pin Amphenol Plug</td> </tr> <tr> <td>2</td> <td>5 Pin Amphenol Plug</td> </tr> <tr> <td>3</td> <td>6 Pin Amphenol Plug</td> </tr> <tr> <td>4</td> <td>14 Pin Amphenol Plug</td> </tr> <tr> <td>5</td> <td>6 Pin Harting Plug</td> </tr> <tr> <td>6</td> <td>8 Pin Plug</td> </tr> <tr> <td>7</td> <td>3 Pin Tuchel Plug</td> </tr> <tr> <td>8</td> <td>9 Pin Tuchel Plug</td> </tr> <tr> <td>9</td> <td>5 Pin Tuchel Plug</td> </tr> <tr> <td>10</td> <td>12 Pin Bundy Plug</td> </tr> </tbody> </table> <p style="font-size: 8px;">NOTE: See Page 31 for Cable Plugs explained</p>	Part No.	Description	0	2 Pin Amphenol Plug	1	4 Pin Amphenol Plug	2	5 Pin Amphenol Plug	3	6 Pin Amphenol Plug	4	14 Pin Amphenol Plug	5	6 Pin Harting Plug	6	8 Pin Plug	7	3 Pin Tuchel Plug	8	9 Pin Tuchel Plug	9	5 Pin Tuchel Plug	10	12 Pin Bundy Plug
Part No.	Description																																																																									
ER9	ER9 125A DC																																																																									
ER9FXL	ER9FXL 125A DC FLEX																																																																									
Part No.	Description																																																																									
12	12.5ft cables (4m) c/w leather cover and sheath																																																																									
25	25ft cables (8m) c/w leather cover and sheath																																																																									
Part No.	Description																																																																									
S1	Momentary Switch																																																																									
S2	2 Button Momentary																																																																									
1K	1 Button Momentary +1K Pot																																																																									
2K	1 Button Momentary +5K Pot																																																																									
3K	1 Button Momentary +10K Pot																																																																									
4K	1 Button Momentary +25K Pot																																																																									
N	Blank																																																																									
Part No.	Description																																																																									
BG	Single 3/8BSP connection																																																																									
EG	Central connector																																																																									
WG	WTG connector																																																																									
LG	L-TEC euro																																																																									
Part No.	Description																																																																									
US	Lug on power, 5/8 UNF RH male on gas																																																																									
UN	Single 5/8 UNF RH male																																																																									
UD	3595 Dinse on power, 5/8 UNF RH male on gas																																																																									
Part No.	Description																																																																									
0	2 Pin Amphenol Plug																																																																									
1	4 Pin Amphenol Plug																																																																									
2	5 Pin Amphenol Plug																																																																									
3	6 Pin Amphenol Plug																																																																									
4	14 Pin Amphenol Plug																																																																									
5	6 Pin Harting Plug																																																																									
6	8 Pin Plug																																																																									
7	3 Pin Tuchel Plug																																																																									
8	9 Pin Tuchel Plug																																																																									
9	5 Pin Tuchel Plug																																																																									
10	12 Pin Bundy Plug																																																																									

A Standard Collet	
Part Number	Description
13N20	Standard Collet 0.020"/0.5mm Bore
13N21	Standard Collet 0.040"/1.0mm Bore
13N22	Standard Collet 1/16"/1.6mm Bore

B Standard Collet Body	
Part Number	Description
13N25	Standard Collet Body 0.020"/0.5mm Bore
13N26	Standard Collet Body 0.040"/1.0mm Bore
13N27	Standard Collet Body 1/16"/1.6mm Bore

C Standard Ceramic Cup	
Part Number	Description
13N08	Standard Ceramic Cup 1/4"/6mm Bore
13N09	Standard Ceramic Cup 5/16"/8mm Bore
13N10	Standard Ceramic Cup 3/8"/10mm Bore
13N11	Standard Ceramic Cup 7/16"/11mm Bore
13N12	Standard Ceramic Cup 1/2"/15mm Bore
13N13	Standard Ceramic Cup 5/8"/16mm Bore

D Long Ceramic Cup	
Part Number	Description
796F74	X Long Ceramic Cup 3/16"/5mm Bore
796F75	X Long Ceramic Cup 1/4"/6mm Bore
796F76	X Long Ceramic Cup 5/16"/8mm Bore
796F77	X Long Ceramic Cup 3/8"/10mm Bore

E Extra Long Ceramic Cup	
Part Number	Description
796F70	Long Ceramic Cup 3/16"/5mm Bore
796F71	Long Ceramic Cup 1/4"/6mm Bore
796F72	Long Ceramic Cup 5/16"/8mm Bore
796F73	Long Ceramic Cup 3/8"/10mm Bore

F Gas Lens Body	
Part Number	Description
45V41	Gas Lens Body 0.020"/0.5mm Bore
45V42	Gas Lens Body 0.040"/1.0mm Bore
45V43	Gas Lens Body 1/16"/1.6mm Bore

G Gas Lens Cup	
Part Number	Description
53N58	Standard Gas Lens Cup 1/4"/6mm Bore
53N59	Standard Gas Lens Cup 5/16"/6mm Bore
53N60	Standard Gas Lens Cup 3/8"/8mm Bore
53N61	Standard Gas Lens Cup 7/16"/10mm Bore
53N61-S	Standard Gas Lens Cup 1/2"/13mm Bore

H Large Diameter Gas Lens Collet	
Part Number	Description
13N22L	Lge Dia Gas Lens Collet 1/16"/1.6mm Bore

I Large Diameter Gas Lens Body	
Part Number	Description
45V116S	Lge Dia Gas Lens Bdy 1/16 Bore"/1.6mm

J Large Diameter Gas Lens Cup	
Part Number	Description
57N75	Lge Dia Gas Lens Cup 3/8"/10mm Bore
57N74	Lge Dia Gas Lens Cup 1/2"/13mm Bore
53N88	Lge Dia Gas Lens Cup 5/8"/16mm Bore
53N87	Lge Dia Gas Lens Cup 3/4"/19mm Bore

Components	
Part Number	Description
1 598882	Cup Gasket
2 ER9FXL	Torch Head Flexible
3 ER9	Torch Head
4 98W77	Back Cap O Ring
5 ER41V24	Ergo Tig Back Cap Long
6 ER41V35	Ergo Tig Back Cap Medium
7 ER41V33	Ergo Tig Back Cap Small
8 ER1MS	Momentary Switch Kit (fitted as Standard) Alternative switch options are listed on Page 2
9 ERSWL4	Switch & Leads x 4mt
ERSWL8	Switch & Leads x 8mt
10 ERH100	Ergo Tig Handle Small
11 ERSP	Screw Pack
12 ERKJ100	Knuckle Joint - Small
13 ERCO100-40	Complete Cover Assembly x 4mt
ERCO100-80	Complete Cover Assembly x 8mt
14 ERLC100-08	Leather Cover x 0.8mt
15 ERNCL-32	Neoprene Cover x 3.2mt
ERNCL-72	Neoprene Cover x 7.2mt
16 ERJK100	Jointing Repair Kit

Alternative end terminations are listed on Page 21

©All rights reserved. No part of this publication maybe reproduced, stored in retrieval system or transmitted by any means, electronic, mechanical , photocopying or otherwise without the prior permission of ©Parweld® the copyright holder.