

Ergo Tig ER18 and ER18FX Water Cooled Tig Welding Torch

Rating: 350A DC, 245A AC 0.020" to 5/32" (1.0mm-4.00mm) electrodes

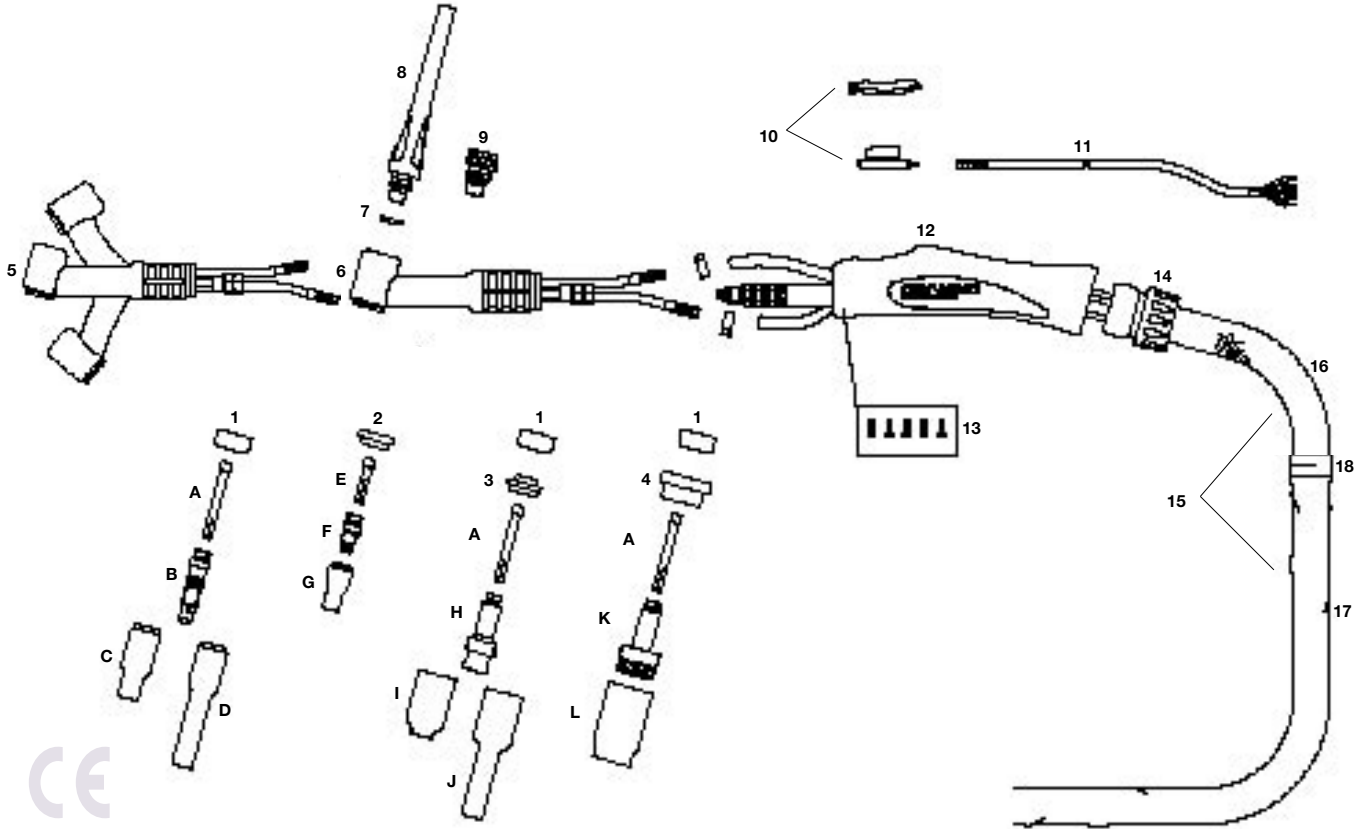

TO ORDER AN ERGO TIG TORCH PACKAGE PLEASE USE THE 5 STAGE PROCESS OUTLINED ON PAGE 1

Example:- ER18FX-25S1BWO

ER18FX Ergo Torch x 25ft with momentary switch, 3/8 BSP fittings and 2 pin Amphenol Plug.

Torch Head	Cable Length	Switch Option	Cable Termination	Cable Plug																																																																								
<table border="1" style="width: 100%; border-collapse: collapse;"> <thead> <tr> <th style="text-align: left;">Part No.</th> <th style="text-align: left;">Description</th> </tr> </thead> <tbody> <tr> <td>ER18</td> <td>ER18 350A DC</td> </tr> <tr> <td>ER18FX</td> <td>ER18FX 350A Flex</td> </tr> </tbody> </table> <p style="font-size: small; margin-top: 5px;">NOTE: See Page 3 for Torch Heads explained</p>	Part No.	Description	ER18	ER18 350A DC	ER18FX	ER18FX 350A Flex	<table border="1" style="width: 100%; border-collapse: collapse;"> <thead> <tr> <th style="text-align: left;">Part No.</th> <th style="text-align: left;">Description</th> </tr> </thead> <tbody> <tr> <td>12</td> <td>12.5ft cables (4m) c/w leather cover and sheath</td> </tr> <tr> <td>25</td> <td>25ft cables (8m) c/w leather cover and sheath</td> </tr> </tbody> </table> <p style="font-size: small; margin-top: 5px;">NOTE: See Page 21 for Cables explained</p>	Part No.	Description	12	12.5ft cables (4m) c/w leather cover and sheath	25	25ft cables (8m) c/w leather cover and sheath	<table border="1" style="width: 100%; border-collapse: collapse;"> <thead> <tr> <th style="text-align: left;">Part No.</th> <th style="text-align: left;">Description</th> </tr> </thead> <tbody> <tr> <td>S1</td> <td>Momentary Switch</td> </tr> <tr> <td>S2</td> <td>2 Button Momentary</td> </tr> <tr> <td>1K</td> <td>1 Button Momentary +1K Pot</td> </tr> <tr> <td>2K</td> <td>1 Button Momentary +5K Pot</td> </tr> <tr> <td>3K</td> <td>1 Button Momentary +10K Pot</td> </tr> <tr> <td>4K</td> <td>1 Button Momentary +25K Pot</td> </tr> <tr> <td>N</td> <td>Blank</td> </tr> </tbody> </table> <p style="font-size: small; margin-top: 5px;">NOTE: See Page 2 for Switches explained</p>	Part No.	Description	S1	Momentary Switch	S2	2 Button Momentary	1K	1 Button Momentary +1K Pot	2K	1 Button Momentary +5K Pot	3K	1 Button Momentary +10K Pot	4K	1 Button Momentary +25K Pot	N	Blank	<table border="1" style="width: 100%; border-collapse: collapse;"> <thead> <tr> <th colspan="2" style="text-align: left;">UK/European Cable Termination</th> </tr> <tr> <th style="text-align: left;">Part No.</th> <th style="text-align: left;">Description</th> </tr> </thead> <tbody> <tr> <td>BW</td> <td>3/8BSP On Water, Gas, Power</td> </tr> <tr> <td>EW</td> <td>Central Connector,</td> </tr> <tr> <td>WW</td> <td>WTW Connector</td> </tr> <tr> <td>LW</td> <td>L-TEC Euro</td> </tr> </tbody> </table> <table border="1" style="width: 100%; border-collapse: collapse;"> <thead> <tr> <th colspan="2" style="text-align: left;">USA Cable Termination</th> </tr> <tr> <th style="text-align: left;">Part No.</th> <th style="text-align: left;">Description</th> </tr> </thead> <tbody> <tr> <td>UW</td> <td>7/8 UNF LH male on power, 5/8 UNF RH male on gas, 5/8 UNF LH male on water</td> </tr> <tr> <td>UE</td> <td>3595 Dinse on power, 5/8 UNF LH on water In/Out, 5/8 UNF RH male on gas</td> </tr> </tbody> </table> <p style="font-size: small; margin-top: 5px;">NOTE: See Page 24 for Terminations explained</p>	UK/European Cable Termination		Part No.	Description	BW	3/8BSP On Water, Gas, Power	EW	Central Connector,	WW	WTW Connector	LW	L-TEC Euro	USA Cable Termination		Part No.	Description	UW	7/8 UNF LH male on power, 5/8 UNF RH male on gas, 5/8 UNF LH male on water	UE	3595 Dinse on power, 5/8 UNF LH on water In/Out, 5/8 UNF RH male on gas	<table border="1" style="width: 100%; border-collapse: collapse;"> <thead> <tr> <th style="text-align: left;">Part No.</th> <th style="text-align: left;">Description</th> </tr> </thead> <tbody> <tr> <td>0</td> <td>2 Pin Amphenol Plug</td> </tr> <tr> <td>1</td> <td>4 Pin Amphenol Plug</td> </tr> <tr> <td>2</td> <td>5 Pin Amphenol Plug</td> </tr> <tr> <td>3</td> <td>6 Pin Amphenol Plug</td> </tr> <tr> <td>4</td> <td>14 Pin Amphenol Plug</td> </tr> <tr> <td>5</td> <td>6 Pin Harting Plug</td> </tr> <tr> <td>6</td> <td>8 Pin Plug</td> </tr> <tr> <td>7</td> <td>3 Pin Tuchel Plug</td> </tr> <tr> <td>8</td> <td>9 Pin Tuchel Plug</td> </tr> <tr> <td>9</td> <td>5 Pin Tuchel Plug</td> </tr> <tr> <td>10</td> <td>12 Pin Bundy Plug</td> </tr> </tbody> </table> <p style="font-size: small; margin-top: 5px;">NOTE: See Page 31 for Cable Plugs explained</p>	Part No.	Description	0	2 Pin Amphenol Plug	1	4 Pin Amphenol Plug	2	5 Pin Amphenol Plug	3	6 Pin Amphenol Plug	4	14 Pin Amphenol Plug	5	6 Pin Harting Plug	6	8 Pin Plug	7	3 Pin Tuchel Plug	8	9 Pin Tuchel Plug	9	5 Pin Tuchel Plug	10	12 Pin Bundy Plug
Part No.	Description																																																																											
ER18	ER18 350A DC																																																																											
ER18FX	ER18FX 350A Flex																																																																											
Part No.	Description																																																																											
12	12.5ft cables (4m) c/w leather cover and sheath																																																																											
25	25ft cables (8m) c/w leather cover and sheath																																																																											
Part No.	Description																																																																											
S1	Momentary Switch																																																																											
S2	2 Button Momentary																																																																											
1K	1 Button Momentary +1K Pot																																																																											
2K	1 Button Momentary +5K Pot																																																																											
3K	1 Button Momentary +10K Pot																																																																											
4K	1 Button Momentary +25K Pot																																																																											
N	Blank																																																																											
UK/European Cable Termination																																																																												
Part No.	Description																																																																											
BW	3/8BSP On Water, Gas, Power																																																																											
EW	Central Connector,																																																																											
WW	WTW Connector																																																																											
LW	L-TEC Euro																																																																											
USA Cable Termination																																																																												
Part No.	Description																																																																											
UW	7/8 UNF LH male on power, 5/8 UNF RH male on gas, 5/8 UNF LH male on water																																																																											
UE	3595 Dinse on power, 5/8 UNF LH on water In/Out, 5/8 UNF RH male on gas																																																																											
Part No.	Description																																																																											
0	2 Pin Amphenol Plug																																																																											
1	4 Pin Amphenol Plug																																																																											
2	5 Pin Amphenol Plug																																																																											
3	6 Pin Amphenol Plug																																																																											
4	14 Pin Amphenol Plug																																																																											
5	6 Pin Harting Plug																																																																											
6	8 Pin Plug																																																																											
7	3 Pin Tuchel Plug																																																																											
8	9 Pin Tuchel Plug																																																																											
9	5 Pin Tuchel Plug																																																																											
10	12 Pin Bundy Plug																																																																											

A Standard Collet

Part Number	Description
10N21	Standard Collet 0.020"/0.5mm Bore
10N22	Standard Collet 0.040"/1.0mm Bore
10N23	Standard Collet 1/16"/1.6mm Bore
10N24	Standard Collet 3/32"/2.4mm Bore
10N25	Standard Collet 1/8"/3.2mm Bore
54N20	Standard Collet 5/32"/4.0mm Bore

B Standard Collet Body

Part Number	Description
10N29	Standard Collet Body 0.020"/0.5mm Bore
10N30	Standard Collet Body 0.040"/1.0mm Bore
10N31	Standard Collet Body 1/16"/1.6mm Bore
10N32	Standard Collet Body 3/32"/2.4mm Bore
10N28	Standard Collet Body 1/8"/3.2mm Bore
406488	Standard Collet Body 5/32"/4.0mm Bore

C Standard Ceramic Cup

Part Number	Description
10N50	Standard Ceramic Cup 1/4"/6mm Bore
10N49	Standard Ceramic Cup 5/16"/8mm Bore
10N48	Standard Ceramic Cup 3/8"/10mm Bore
10N47	Standard Ceramic Cup 7/16"/11mm Bore
10N46	Standard Ceramic Cup 1/2"/15mm Bore
10N45	Standard Ceramic Cup 5/8"/16mm Bore
10N44	Standard Ceramic Cup 3/4"/19mm Bore

D Long Ceramic Cup

Part Number	Description
10N49L	Long Ceramic Cup 5/16"/8mm Bore
10N48L	Long Ceramic Cup 3/8"/10mm Bore
10N47L	Long Ceramic Cup 7/16"/11mm Bore

E Stubby Collet

Part Number	Description
10N21S	Stubby Collet 0.020"/0.5mm Bore
10N22S	Stubby Collet 0.040"/1.0mm Bore
10N23S	Stubby Collet 1/16"/1.6mm Bore
10N24S	Stubby Collet 3/32"/2.4mm Bore
10N25S	Stubby Collet 1/8"/3.2mm Bore

F Stubby Collet Body

Part Number	Description
17CB20	Stubby Collet Body 0.020"/1.8mm Bore

G Standard Ceramic Cup

Part Number	Description
13N08	Standard Ceramic Cup 1/4"/6mm Bore
13N09	Standard Ceramic Cup 5/16"/8mm Bore
13N10	Standard Ceramic Cup 3/8"/10mm Bore
13N11	Standard Ceramic Cup 7/16"/11mm Bore
13N12	Standard Ceramic Cup 1/2"/13mm Bore
13N13	Standard Ceramic Cup 5/8"/16mm Bore

H Gas Lens Body

Part Number	Description
45V29	Gas Lens Body 0.020"/0.5mm Bore
45V24	Gas Lens Body 0.040"/1.0mm Bore
45V25	Gas Lens Body 1/16"/1.6mm Bore
45V26	Gas Lens Body 3/32"/2.4mm Bore
45V27	Gas Lens Body 1/8"/3.2mm Bore
45V28	Gas Lens Body 5/32"/4.0mm Bore

I Standard Gas Lens Cup

Part Number	Description
54N18	Standard Gas Lens Cup 1/4"/6mm Bore
54N17	Standard Gas Lens Cup 5/16"/8mm Bore
54N16	Standard Gas Lens Cup 3/8"/10mm Bore
54N15	Standard Gas Lens Cup 7/16"/11mm Bore
54N14	Standard Gas Lens Cup 1/2"/13mm Bore
54N19	Standard Gas Lens Cup 1/16"/18mm Bore

J Long Gas Lens Cup

Part Number	Description
54N17L	Long Gas Lens Cup 5/16"/8mm Bore
54N16L	Long Gas Lens Cup 3/8"/10mm Bore
54N15L	Long Gas Lens Cup 7/16"/11mm Bore

K Large Diameter Gas Lens Body

Part Number	Description
45V116	Lge Dia Gas Lens Bdy 1/16"/1.6mm Bore
45V64	Large Dia Gas Lens Body 3/32"/2.4mm Bore
995795	Large Dia Gas Lens Body 1/8"/3.2mm Bore
45V63	Large Dia Gas Lens Body 5/32"/4.0mm Bore

L Large Diameter Gas Lens Cup

Part Number	Description
57N75	Lge Dia Gas Lens Cup 3/8"/10mm Bore
57N74	Lge Dia Gas Lens Cup 1/2"/13mm Bore
53N88	Lge Dia Gas Lens Cup 5/8"/16mm Bore
53N87	Lge Dia Gas Lens Cup 3/4"/19mm Bore

Components

Part Number	Description
1 18CG	Cup Gasket
2 18CG20	Cup Gasket
3 54N01	Gas Lens Insulator
4 54N63	Insulator Large Dia G/Lens
5 ER18FX	Torch Head Flexible
6 ER18	Torch Head Angled with Gasket
7 98W18	Back Cap O Ring
8 ER57Y02	Back Cap Long
9 ER57Y04	Back Cap Short
10 ER1MS	Momentary Switch Kit (fitted as Standard) Alternative switch options are listed on Page 2
11 ERSWL4	Switch & Leads x 4mt
ERSWL8	Switch & Leads x 8mt
12 ERH200	Ergo Tig Handle Large
13 ERSP	Screw Pack
14 ERKJ200	Knuckle Joint Large
15 ERCO200-40	Complete Cover Assembly x 4mt
ERCO200-80	Complete Cover Assembly x 8mt
16 ERLC200-08	Leather Cover x 0.8mt
17 ERNCL-32	Neoprene Cover x 3.2mt
ERNCL-72	Neoprene Cover x 7.2mt
18 ERJK200	Jointing Repair Kit

Alternative end terminations are listed on Page 21