

# Ergo Tig ER17 and ER17FX Air Cooled Tig Welding Torch

Rating: 150A DC, 105A AC 0.040" to 3/32" (1.00mm-2.4mm) electrodes

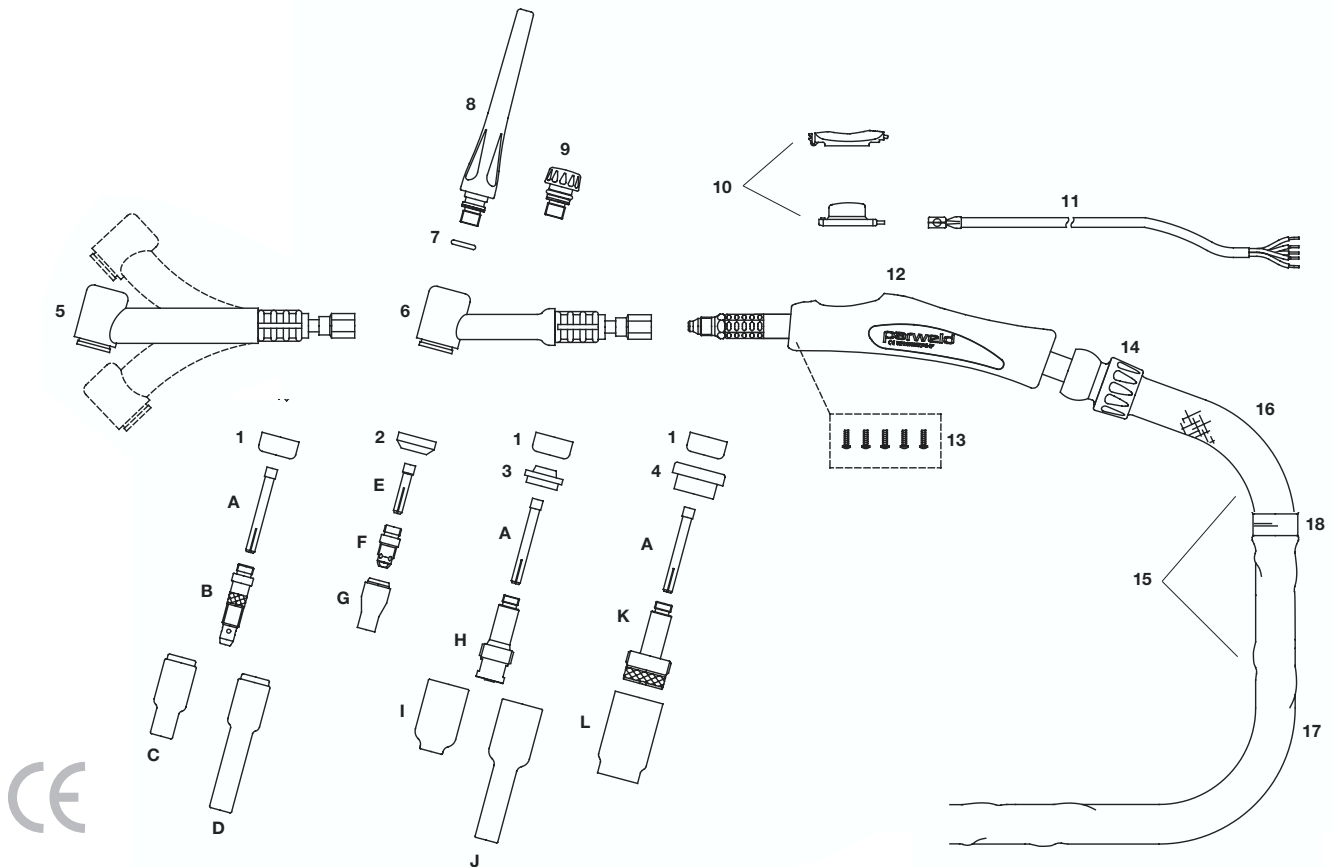

## TO ORDER AN ERGO TIG TORCH PACKAGE PLEASE USE THE 5 STAGE PROCESS OUTLINED ON PAGE 1

Example:- ER17FX-12S1BGO

ER17FX Ergo Torch x 12.5ft with momentary switch, 3/8 BSP fittings and 2 pin Amphenol Plug.

Torch Head		Cable Length		Switch Option		Cable Termination		Cable Plug	
Part No.	Description	Part No.	Description	Part No.	Description	Part No.	Description	Part No.	Description
ER17	ER17 150A DC	12	12.5ft cables (4m) c/w leather cover and sheath	S1	Momentary Switch	US	Lug on power, 5/8 UNF RH male on gas	0	2 Pin Amphenol Plug
ER17FX	ER17FX 150A DC FLEX	25	25ft cables (8m) c/w leather cover and sheath	S2	2 Button Momentary	UN	Single 5/8 UNF RH male	1	4 Pin Amphenol Plug
NOTE: See Page 3 for Torch Heads explained		NOTE: See Page 21 for Cables explained		NOTE: See Page 2 for Switches explained		NOTE: See Page 22 for Terminations explained		NOTE: See Page 31 for Cable Plugs explained	
						<b>UK/European Cable Termination</b> BG Single 3/8BSP connection EG Central connector WG WTG connector LG L-TEC euro			
						<b>USA Cable Termination</b> US Lug on power, 5/8 UNF RH male on gas UN Single 5/8 UNF RH male UD 3595 Dinse on power, 5/8 UNF RH male on gas A Single 3/8 UNF RH male			
								2 5 Pin Amphenol Plug 3 6 Pin Amphenol Plug 4 14 Pin Amphenol Plug 5 6 Pin Harting Plug 6 8 Pin Plug 7 3 Pin Tuchel Plug 8 9 Pin Tuchel Plug 9 5 Pin Tuchel Plug 10 12 Pin Bundy Plug	

### A Standard Collet

Part Number	Description
10N21	Standard Collet 0.020"/0.5mm Bore
10N22	Standard Collet 0.040"/1.0mm Bore
10N23	Standard Collet 1/16"/1.6mm Bore
10N23M	Standard Collet 5/64"/2.0mm Bore
10N24	Standard Collet 3/32"/2.4mm Bore

### B Standard Collet Body

Part Number	Description
10N29	Standard Collet Body .020"/0.5mm Bore
10N30	Standard Collet Body .040"/1.0mm Bore
10N31	Standard Collet Body 1/16"/1.6mm Bore
10N32	Standard Collet Body 3/32"/2.4mm Bore

### C Standard Ceramic Cup

Part Number	Description
10N50	Standard Ceramic Cup 1/4"/6mm Bore
10N49	Standard Ceramic Cup 5/16"/8mm Bore
10N48	Standard Ceramic Cup 3/8"/10mm Bore
10N47	Standard Ceramic Cup 7/16"/11mm Bore
10N46	Standard Ceramic Cup 1/2"/13mm Bore
10N45	Standard Ceramic Cup 5/8"/16mm Bore
10N44	Standard Ceramic Cup 3/4"/19mm Bore

### D Standard Long Ceramic Cup

Part Number	Description
10N49L	Long Ceramic Cup 5/16"/8mm Bore
10N48L	Long Ceramic Cup 3/8"/10mm Bore
10N47L	Long Ceramic Cup 7/16"/11mm Bore

### E Stubby Series Collet

Part Number	Description
10N21S	Stubby Collet 0.020"/0.5mm Bore
10N22S	Stubby Collet 0.040"/1.0mm Bore
10N23S	Stubby Collet 1/16"/1.6mm Bore
10N24S	Stubby Collet 3/32"/2.4mm Bore

### F Stubby Collet Body

Part Number	Description
17CB20	Stubby Collet Body 0.020"/1.8mm Bore

### G Stubby Series Ceramic Cup

Part Number	Description
13N08	Standard Ceramic Cup 1/4"/6mm Bore
13N09	Standard Ceramic Cup 5/16"/8mm Bore
13N10	Standard Ceramic Cup 3/8"/10mm Bore
13N11	Standard Ceramic Cup 7/16"/11mm Bore
13N12	Standard Ceramic Cup 1/2"/15mm Bore
13N13	Standard Ceramic Cup 5/8"/16mm Bore

### H Gas Lens Body

Part Number	Description
45V29	Gas Lens Body 0.020"/0.5mm Bore
45V24	Gas Lens Body 0.040"/1.0mm Bore
45V25	Gas Lens Body 1/16"/1.6mm Bore
45V26	Gas Lens Body 3/32"/2.4mm Bore

### I Standard Gas Lens Cup

Part Number	Description
54N18	Standard Gas Lens Cup 1/4"/6mm Bore
54N17	Standard Gas Lens Cup 5/16"/8mm Bore
54N16	Standard Gas Lens Cup 3/8"/10mm Bore
54N15	Standard Gas Lens Cup 7/16"/11mm Bore
54N14	Standard Gas Lens Cup 1/2"/15mm Bore
54N19	Standard Gas Lens Cup 1/16"/18mm Bore

### J Long Gas Lens Cup

Part Number	Description
54N17L	Long Gas Lens Cup 5/16"/8mm Bore
54N16L	Long Gas Lens Cup 3/8"/10mm Bore
54N15L	Long Gas Lens Cup 7/16"/11mm Bore

### K Large Diameter Gas Lens Body

Part Number	Description
45V116	Lge Dia Gas Lens Bdy 1/16"/1.6mm Bore
45V64	Large Dia Gas Lens Body 3/32"/2.4mm Bore

### L Large Diameter Gas Lens Cup

Part Number	Description
57N75	Lge Dia Gas Lens Cup 3/8"/10mm Bore
57N74	Lge Dia Gas Lens Cup 1/2"/13mm Bore
53N88	Lge Dia Gas Lens Cup 5/8"/16mm Bore
53N87	Lge Dia Gas Lens Cup 3/4"/19mm Bore

### Components

Part Number	Description
1 18CG	Cup Gasket
2 18CG20	Cup Gasket
3 54N01	Gas Lens Insulator
4 54N63	Insulator Large Dia G/Lens
5 ER17FX	Torch Head Flexible
6 ER17	Torch Head Angled with Gasket
7 98W18	Back Cap O Ring
8 ER57Y02	Back Cap Long
9 ER57Y04	Back Cap Short
10 ER1MS	Momentary Switch Kit (fitted as Standard) Alternative switch options are listed on Page 2
11 ERSWL4	Switch & Leads x 4mt
ERSWL8	Switch & Leads x 8mt
12 ERH100	Ergo Tig Handle Small
13 ERSP	Screw Pack
14 ERKJ100	Knuckle Joint - Small
15 ERCO100-40	Complete Cover Assembly x 4mt
ERCO100-80	Complete Cover Assembly x 8mt
16 ERLC100-08	Leather Cover x 0.8mt
17 ERNCL-32	Neoprene Cover x 3.2mt
ERNCL-72	Neoprene Cover x 7.2mt
18 ERJK100	Jointing Repair Kit

Alternative end terminations are listed on Page 21