

Ergo Tig ER17 and ER17FX Air Cooled Tig Welding Torch

Rating: 150A DC, 105A AC 0.040" to 3/32" (1.00mm-2.4mm) electrodes

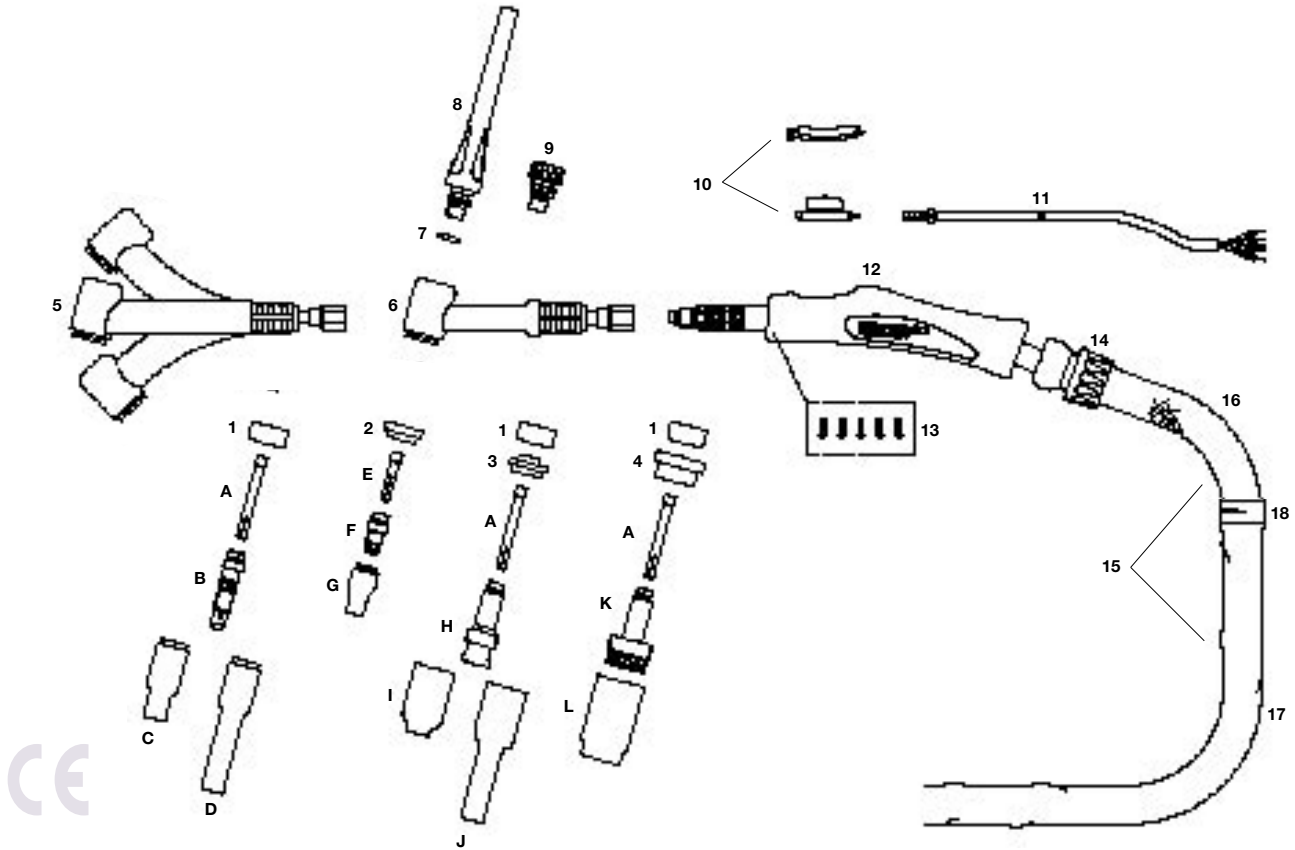

TO ORDER AN ERGO TIG TORCH PACKAGE PLEASE USE THE 5 STAGE PROCESS OUTLINED ON PAGE 1

Example:- ER17FX-12S1BGO

ER17FX Ergo Torch x 12.5ft with momentary switch, 3/8 BSP fittings and 2 pin Amphenol Plug.

Torch Head	Cable Length	Switch Option	Cable Termination	Cable Plug
------------	--------------	---------------	-------------------	------------

Part No.	Description
ER17	ER17 150A DC
ER17FX	ER17FX 150A DC FLEX

NOTE: See Page 3 for Torch Heads explained

Part No.	Description
12	12.5ft cables (4m) c/w leather cover and sheath
25	25ft cables (8m) c/w leather cover and sheath

NOTE: See Page 21 for Cables explained

Part No.	Description
S1	Momentary Switch
S2	2 Button Momentary
1K	1 Button Momentary +1K Pot
2K	1 Button Momentary +5K Pot
3K	1 Button Momentary +10K Pot
4K	1 Button Momentary +25K Pot
N	Blank

NOTE: See Page 2 for Switchs explained

UK/European Cable Termination	
Part No.	Description
BG	Single 3/8BSP connection
EG	Central connector
WG	WTG connector
LG	L-TEC euro

USA Cable Termination	
Part No.	Description
US	Lug on power, 5/8 UNF RH male on gas
UN	Single 5/8 UNF RH male
UD	3595 Dinse on power, 5/8 UNF RH male on gas
A	Single 3/8 UNF RH male

NOTE: See Page 22 for Terminations explained

Part No.	Description
0	2 Pin Amphenol Plug
1	4 Pin Amphenol Plug
2	5 Pin Amphenol Plug
3	6 Pin Amphenol Plug
4	14 Pin Amphenol Plug
5	6 Pin Harting Plug
6	8 Pin Plug
7	3 Pin Tuchel Plug
8	9 Pin Tuchel Plug
9	5 Pin Tuchel Plug
10	12 Pin Bundy Plug

NOTE: See Page 31 for Cable Plugs explained

A Standard Collet

Part Number	Description
10N21	Standard Collet 0.020"/0.5mm Bore
10N22	Standard Collet 0.040"/1.0mm Bore
10N23	Standard Collet 1/16"/1.6mm Bore
10N23M	Standard Collet 5/64"/2.0mm Bore
10N24	Standard Collet 3/32"/2.4mm Bore

B Standard Collet Body

Part Number	Description
10N29	Standard Collet Body .020"/0.5mm Bore
10N30	Standard Collet Body .040"/1.0mm Bore
10N31	Standard Collet Body 1/16"/1.6mm Bore
10N32	Standard Collet Body 3/32"/2.4mm Bore

C Standard Ceramic Cup

Part Number	Description
10N50	Standard Ceramic Cup 1/4"/6mm Bore
10N49	Standard Ceramic Cup 5/16"/8mm Bore
10N48	Standard Ceramic Cup 3/8"/10mm Bore
10N47	Standard Ceramic Cup 7/16"/11mm Bore
10N46	Standard Ceramic Cup 1/2"/13mm Bore
10N45	Standard Ceramic Cup 5/8"/16mm Bore
10N44	Standard Ceramic Cup 3/4"/19mm Bore

D Standard Long Ceramic Cup

Part Number	Description
10N49L	Long Ceramic Cup 5/16"/8mm Bore
10N48L	Long Ceramic Cup 3/8"/10mm Bore
10N47L	Long Ceramic Cup 7/16"/11mm Bore

E Stubby Series Collet

Part Number	Description
10N21S	Stubby Collet 0.020"/0.5mm Bore
10N22S	Stubby Collet 0.040"/1.0mm Bore
10N23S	Stubby Collet 1/16"/1.6mm Bore
10N24S	Stubby Collet 3/32"/2.4mm Bore

F Stubby Collet Body

Part Number	Description
17CB20	Stubby Collet Body 0.020"/1.8mm Bore

G Stubby Series Ceramic Cup

Part Number	Description
13N08	Standard Ceramic Cup 1/4"/6mm Bore
13N09	Standard Ceramic Cup 5/16"/8mm Bore
13N10	Standard Ceramic Cup 3/8"/10mm Bore
13N11	Standard Ceramic Cup 7/16"/11mm Bore
13N12	Standard Ceramic Cup 1/2"/15mm Bore
13N13	Standard Ceramic Cup 5/8"/16mm Bore

H Gas Lens Body

Part Number	Description
45V29	Gas Lens Body 0.020"/0.5mm Bore
45V24	Gas Lens Body 0.040"/1.0mm Bore
45V25	Gas Lens Body 1/16"/1.6mm Bore
45V26	Gas Lens Body 3/32"/2.4mm Bore

I Standard Gas Lens Cup

Part Number	Description
54N18	Standard Gas Lens Cup 1/4"/6mm Bore
54N17	Standard Gas Lens Cup 5/16"/8mm Bore
54N16	Standard Gas Lens Cup 3/8"/10mm Bore
54N15	Standard Gas Lens Cup 7/16"/11mm Bore
54N14	Standard Gas Lens Cup 1/2"/15mm Bore
54N19	Standard Gas Lens Cup 1/16"/18mm Bore

J Long Gas Lens Cup

Part Number	Description
54N17L	Long Gas Lens Cup 5/16"/8mm Bore
54N16L	Long Gas Lens Cup 3/8"/10mm Bore
54N15L	Long Gas Lens Cup 7/16"/11mm Bore

K Large Diameter Gas Lens Body

Part Number	Description
45V116	Lge Dia Gas Lens Bdy 1/16"/1.6mm Bore
45V64	Large Dia Gas Lens Body 3/32"/2.4mm Bore

L Large Diameter Gas Lens Cup

Part Number	Description
57N75	Lge Dia Gas Lens Cup 3/8"/10mm Bore
57N74	Lge Dia Gas Lens Cup 1/2"/13mm Bore
53N88	Lge Dia Gas Lens Cup 5/8"/16mm Bore
53N87	Lge Dia Gas Lens Cup 3/4"/19mm Bore

Components

Part Number	Description
1	18CG Cup Gasket
2	18CG20 Cup Gasket
3	54N01 Gas Lens Insulator
4	54N63 Insulator Large Dia G/Lens
5	ER17FX Torch Head Flexible
6	ER17 Torch Head Angled with Gasket
7	98W18 Back Cap O Ring
8	ER57Y02 Back Cap Long
9	ER57Y04 Back Cap Short
10	ER1MS Momentary Switch Kit (fitted as Standard) Alternative switch options are listed on Page 2
11	ERSWL4 Switch & Leads x 4mt
	ERSWL8 Switch & Leads x 8mt
12	ERH100 Ergo Tig Handle Small
13	ERSP Screw Pack
14	ERKJ100 Knuckle Joint - Small
15	ERCO100-40 Complete Cover Assembly x 4mt
	ERCO100-80 Complete Cover Assembly x 8mt
16	ERLC100-08 Leather Cover x 0.8mt
17	ERNCL-32 Neoprene Cover x 3.2mt
	ERNCL-72 Neoprene Cover x 7.2mt
18	ERJK100 Jointing Repair Kit

Alternative end terminations are listed on Page 21