

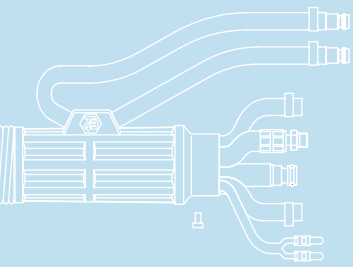

Top 2000 TBi 5W

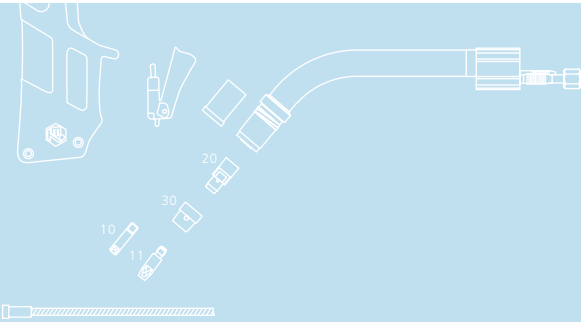

Watercooling

Compact and lightweight

Screw-on gas nozzles

Technical data

MIG / MAG (GMAW) Semi-automatic welding torch TBi 5W

Rating at 100% duty cycle
(10 min. cycle)

- Mixed gas: 300 A
- CO₂: 350 A

Cooling method Watercooling

Wire diameter 0.8 - 1.2 mm

Gas flow 12 l/min

Technical specification according to IEC 60974-7

Weight with 1.5m cable 1.50 kg

Connection Euro-Central connector
Other connectors (e.g. Cloos®, ESAB®) available upon request.

Ordering Information

TBi 5W ESW, 50° bent 176P4425_0

* At the blank, please insert 3, 4 or 5 for a torch length of 3, 4 or 5m.

Torch rating will be reduced when using pulsed-arc power sources.
Special torch necks and custom lengths of the cable assembly are available upon request.

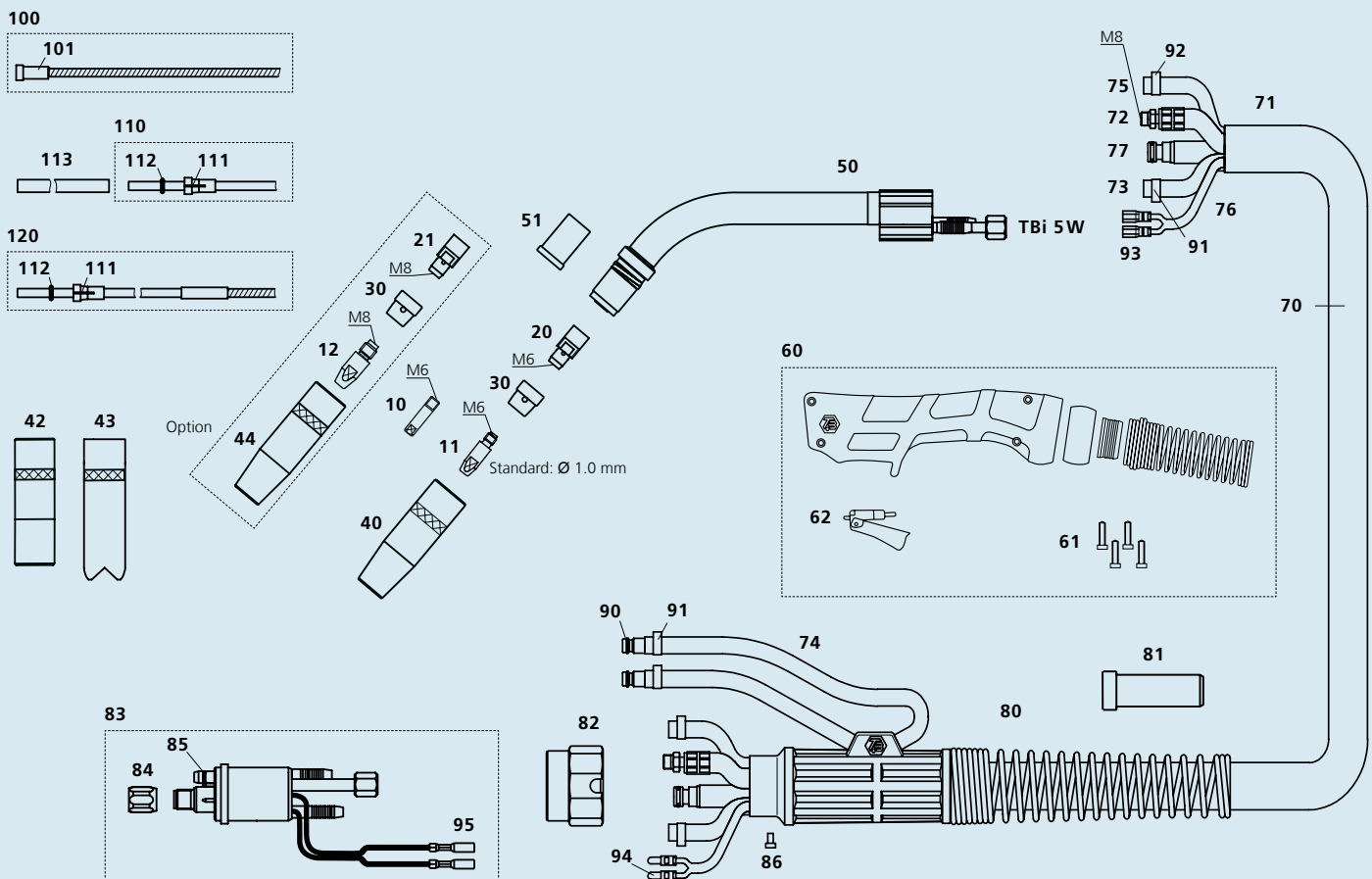

Pos.	Description	Part. No.	Pos.	Description	Part. No.
Contact tips					
10	Contact tip M6x25, Ecu	340P_1073*	70	Cable assembly TBi Top 2000	171P4S45_0*
10	Contact tip M6x25, CuCrZr	340P_3073*	71	Fabric outer cover 25x1.5 mm, cpl.	307P2528_A*
10	Contact tip M6x25 Alu, Ecu	341P_1073*	72	Rubber water-power cable (Top 2000)	314P1622_0*
▶ 11	Contact tip M6x28, Ecu	340P_1069*	73	Rubber hose, blue, 5x1.5 mm	303P150000
11	Contact tip M6x28, CuCrZr	340P_3069*	74	Rubber hose, red, 5x1.5 mm	303P160000
11	Contact tip M6x28 Alu, Ecu	341P_1069*	75	PVC-Gas hose, black 4.5x1.5 mm	302P010000
12	Contact tip M8x30, Ecu	340P_1262*	76	Control cable x.30 m cpl.	301P2304_0*
12	Contact tip M8x30, CuCrZr	340P_3262*	77	Wire conduit yellow (Top 2000)	356P0C0C_0*
12	Contact tip M8x30 Alu, Ecu	341P_1262*	80	Cable support 3 parts cpl. with spring	701P101071
Tip holders					
▶ 20	Tip holder M6, CuCrZr	342P006176	81	Cable support 70 sqmm	600P002107
21	Tip holder M8, CuCrZr	342P008176	82	Adaptor nut	701P001013
Gas diffusers					
▶ 30	Gas diffuser	174P102090	83	Central adaptor ESW cpl., moveable pins (Top 2000)	701P101006
30	Gas diffuser, heavy duty	174P102091	84	Sleeve nut M10x1	701P002005
Gas nozzles					
▶ 40	Nozzle con. diam. 12.5 mm	345P012176	85	O-ring 4.0x1.0 mm (gas nipple)	365P100040
40	Nozzle con. diam. 12.5 mm HD	345P012276	86	Slotted screw M4x6	100P008401
42	Nozzle cyl. diam. 17.0 mm	345P011176	90	Quick connector	701P002064
43	Spot weld nozzle diam. 17.0 mm	345P125176	91	Hose clamp Ø 9.5 with ring	373P100095
44	Nozzle con. diam. 12.5 mm for M8 contact tip	345PA12176	92	Hose clamp Ø 8.7	371P000087
Spare parts					
50	Torch neck TBi 5W, 50°	176P101006	93	Cable lug, flat	375P000023
51	Insulating bushing	176P102007	94	Insulated connector, male, round	375P000004
60	Handle blue, watercooled, cpl. kit	380P220401	95	Insulated connector, female, round	375P000003
61	Cross recessed screw M3.5x14	100P008413	Wire guides		
62	Trigger, red, 2 poles	385P021016	100	Liner w/ insulation blue (x.40 m) for wire 0.8-1.0	324P1545_4*
Wire guides					
▶ 100	Liner w/o insulation (x.40 m) for wire 1.0-1.2	322P2045_4*	101	Collet for liners dia. 4.5 mm	330P025045
110	Teflon liner blue (x.50 m) for wire 0.6-0.9	326P1540_5*	110	Teflon liner blue (x.50 m) for wire 0.6-0.9	326P1540_5*
110	Teflon liner red (x.50 m) for wire 1.0-1.2	326P2040_5*	111	Collet for teflon and PA liner 2.0x4.0 mm	331P020040
111	Collet for teflon and PA liner 2.0x4.0 mm	331P020040	112	O-ring 3.50x1.50 mm (teflon liner)	365P150035
112	O-ring 3.50x1.50 mm (teflon liner)	365P150035	113	Support tube 5x4.4 mm, L=150 mm	329P544150
113	Support tube 5x4.4 mm, L=150 mm	329P544150	120	PA-Alu wire guide (x.50 m) for wire 1.0-1.2	328P2040_A*
120	PA-Alu wire guide (x.50 m) for wire 1.0-1.2	328P2040_A*			

▶ = Standard equipment

* At the blank, please insert suitable information for torch length or wire diameter, e.g. 08 for 0.8 mm or 3 for 3 m.

© 2006 TBI Industries GmbH. All rights reserved. Subject to change without notice. Warranty only when using original TBI consumables and spare parts. Excerpts and reprints not permitted. Nr. DOKP112152, 03/2006.

TBI Industries GmbH
Ruhberg 14
D-35463 Fernwald-Steinbach
P.O. Box 67
D-35461 Fernwald-Steinbach

Tel. + 49 6404 9171-0
Fax. + 49 6404 9171-40
Internet: www.tbi-industries.com
E-mail: info@tbi-industries.com